

35

45



**KOMATSU**<sup>™</sup>  
HIGH PERFORMANCE SHOULD NOT BE OPTIONAL<sup>®</sup>

60

AC

KOMATSU

**KOMATSU OBS60**

AO

AL

AA

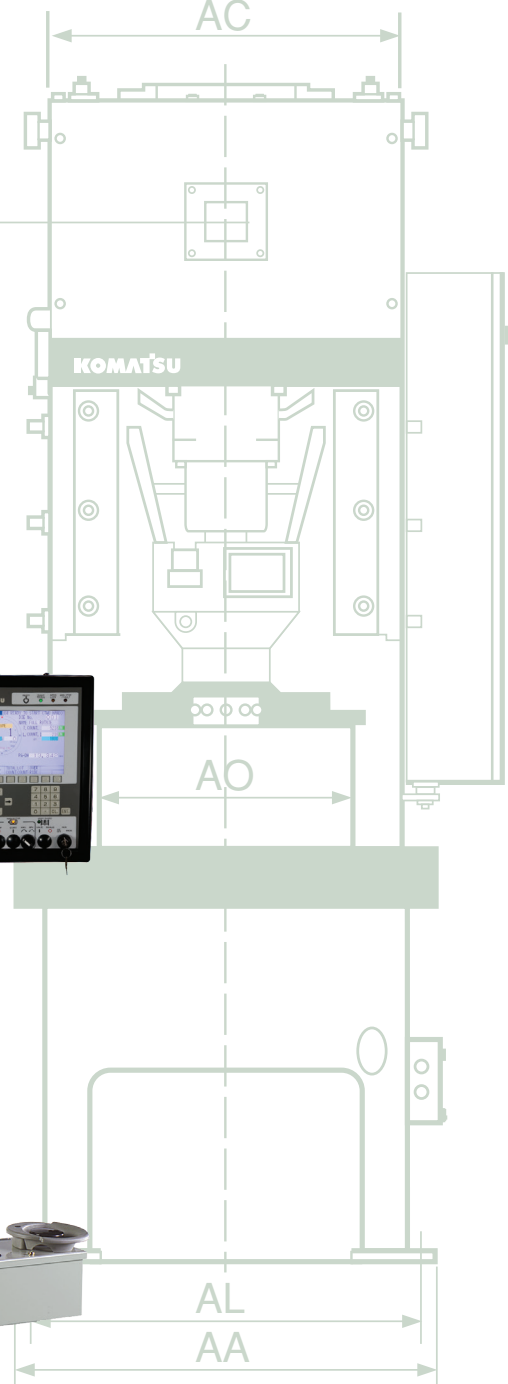

## Capacity Curves

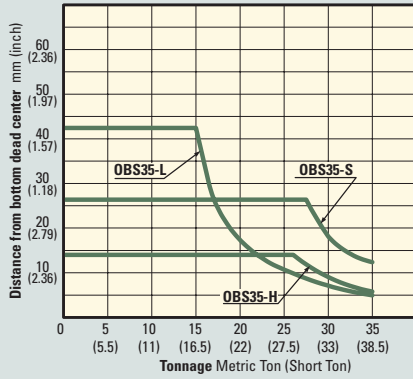

**OBS 35**

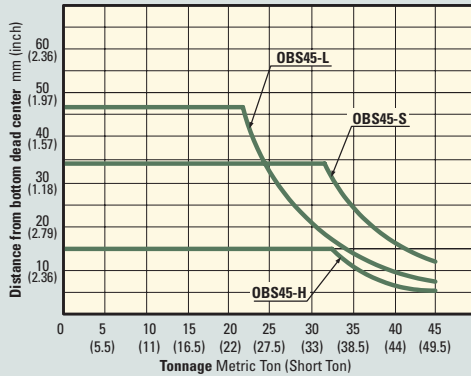

**OBS 45**

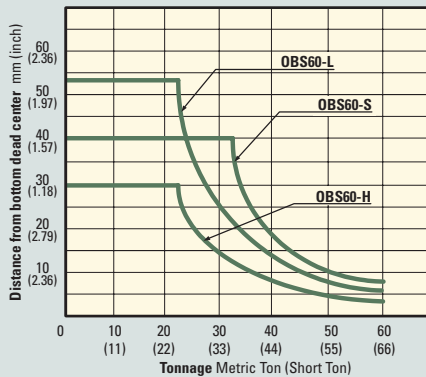

**OBS 60**

## General View

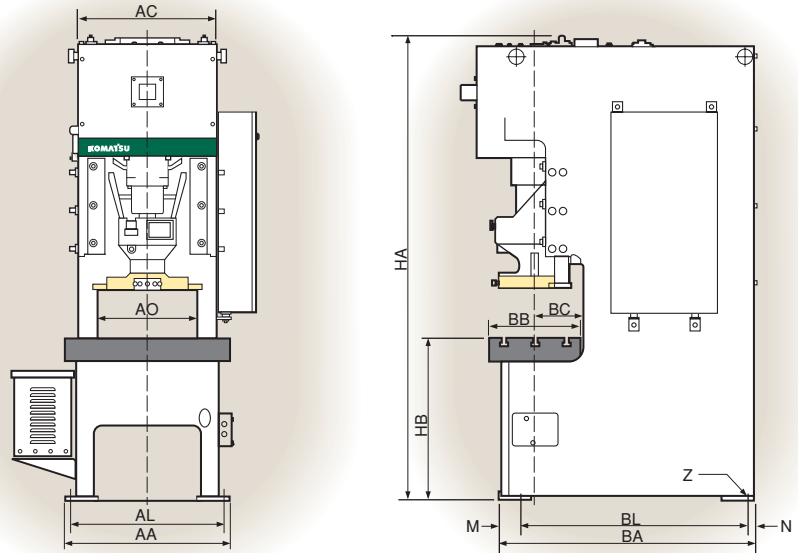

## Dimensions (All inches)

Model	OBS35			OBS45			OBS60		
Type	S	H	L	S	H	L	S	H	L
AA	29.9"			31.9"			37.8"		
AC	24.4"			26.4"			32.3"		
AL	27.5"			29.5"			35.4"		
AO	17.4"			19.1"			23.6"		
BA	47.3"			49.9"			54.3"		
BB	15.7"			17.7"			21.6"		
BC	8.3"			9.4"			11.2"		
BL	40.4"			44.3"			47.8"		
HA	83.5"	89.8"		90.9"	93.7"		105.7"	108.3"	
HB	31.5"			31.5"			35.4"		
M	3.7"			4"			3"		
N	3.2"			1.6"			3.5"		
Z	ø1.26"			ø1.26"			ø1.26"		

## Specifications (All inches)

Model	OBS35			OBS45			OBS60			
	Type	S	H	L	S	H	L	S	H	L
Max. Capacity	short ton	38.5			49.5			66		
Limit of capacity	in.	0.47	0.24	0.2	0.43	0.26	0.28	0.30	0.12	0.22
Slide strokes	in.	3.1	1.6	5.1	3.9	2.0	5.5	4.7	3.5	6.3
Variable speed range	spm	60-120	120-240	50-100	50-100	100-200	50-100	42-85	75-150	42-85
Die height	in.	8.3		11.4	9.8		11.8	11.8		13.8
Slide adjustment	in.	2.2			2.4			2.8		
Slide dimensions (widthxdepth)	in.	13.8 x 11.8			15.7 x 13.8			19.7 x 15.7		
Diameter of shank hole	in.	ø2.0			ø2.0			ø2.0		
Bolster (widthxdepthxthickness)	in.	27.6 x 15.7 x 3.4			31.5 x 17.7 x 4.3			35.4 x 21.7 x 5.1		
Motor output	kW	3.7			3.7			5.5		

Specifications subject to change without notice.

**KOMATSU**  
TOMORROW'S TECHNOLOGY TODAY

[www.komatsupress.com](http://www.komatsupress.com)

### America HQ

Komatsu America Industries, LLC  
8770 W. Bryn Mawr Ave., Suite 100  
Chicago, IL 60631  
Phone: 847-437-3888  
Fax: 847-437-1811

### Mexico HQ

Komatsu Industries Mexico, S.A. de C.V. (KIMX)  
Municipio de Rincón de Romos # 102-A  
Parque Industrial Valle de Aguascalientes  
San Francisco de los Romos, Aguascalientes, C.P. 20358  
Tel : +52 (449) 973-9700